

UNIBODY-HX



- Heavy Duty - Contractor Grade Dump Body Design
- AR - High Quality, Long Lasting Steel Material
- Smooth Clean Sides And Tailgate For Ease Of Maintenance And Space For Signs Or Decals.
- Optional Bolt On Cabshield

The Unibody HX is a contractor-grade dump body engineered for heavy-duty hauling applications. It is constructed using industry-renowned AR500 and AR450 abrasion-resistant steel across critical structural components, including the sides, tailgate, headboard, and floor. The integrated unibody design delivers a streamlined appearance while maximizing structural integrity, durability, and operational efficiency during high-impact dumping operations.



	S1156-H1-B1A4A-IB-BA5-1011-DPM	S1156-H1-B9D9A-EE-EA5-2011-DPM
LENGTH	15'6"	15'6"
RECOMMENDED CA	126"-135" CA	126"-135" CA
HEADBOARD HEIGHT	87"	87"
SIDE HEIGHT	30"	42"
CYLINDER CAPACITY	30 Ton Mailhot	30 Ton Mailhot
TAILGATE HEIGHT OPTIONS	48" Angled (Air Latched)	60" Straight (Air Latched)
SIDE MATERIAL	1/8" AR450	5/32" AR450
TAILGATE MATERIAL	3/16" AR200	3/16" AR450
HEADBOARD MATERIAL	1/8" AR200	5/32" AR450
FLOOR MATERIAL	3/16" AR200	3/16" AR450
REAR LIGHTING	LED 4 - STT, 2 Reverse, 5 Rear Markers, 2 Front Markers	LED 4 - STT, 2 Reverse, 5 Rear Markers, 2 Front Markers
WEIGHT (LBS)	TBD	TBD

Specs subject to change without notice. Consult with factory for more information.

S1156-H1-B1A4A-IB-BA5-1011-DPM

S1156-H1-B9D9A-EE-EA5-2011-DPM

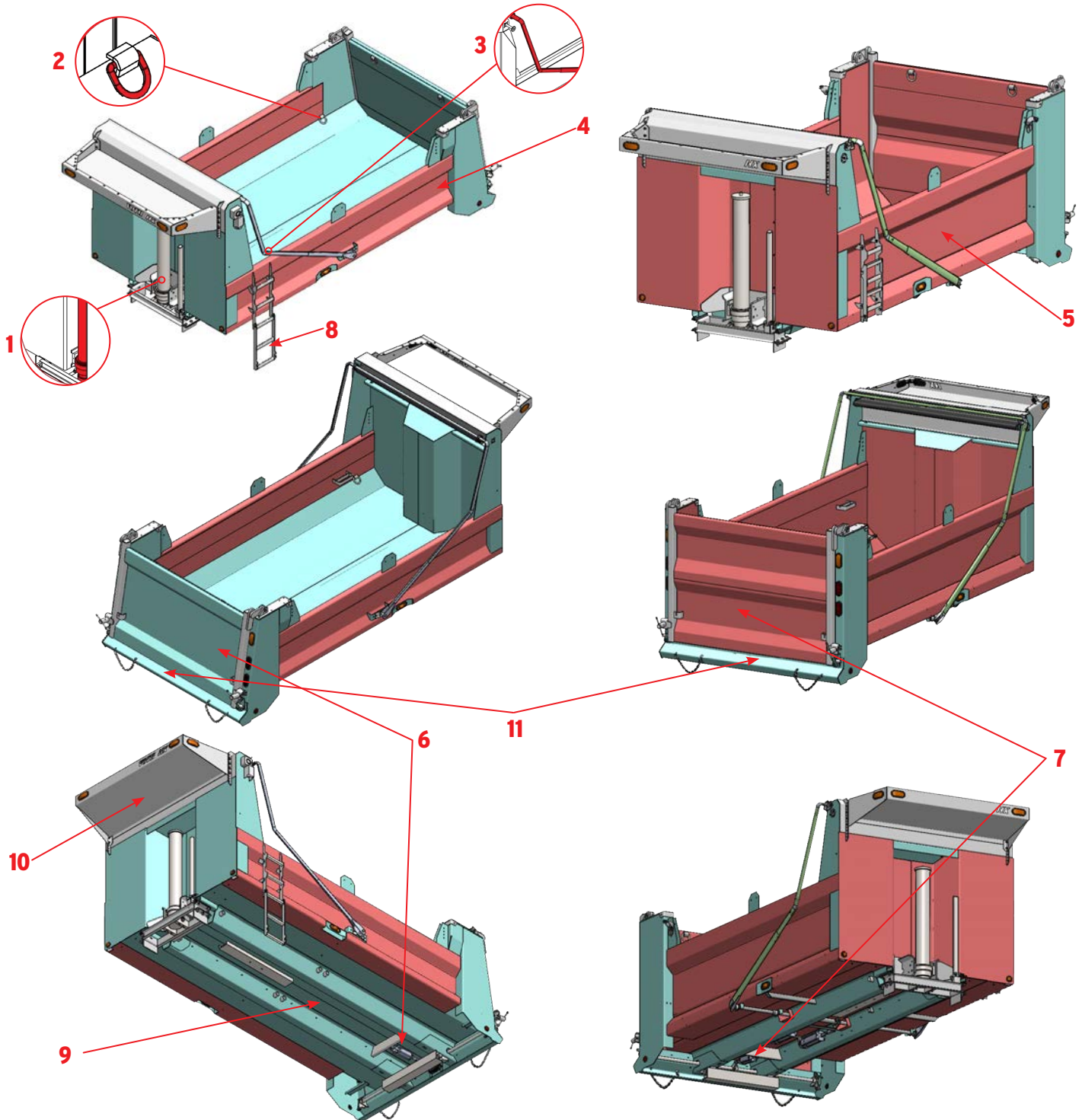

UNIBODY-HX BODY FEATURES

- | | |
|---|--|
| 1. MAILHOT 30 TON | 7. 60" AIR LATCHED TAILGATE (HIGH LIFT OPTIONAL) |
| 2. D-RINGS IN ALL 4 CORNERS (2 D-RINGS ON TAILGATE) | 8. ACCESS LADDER (OPTIONAL) |
| 3. ELECTRIC TARP WITH SIDE ARMS (ELECTRIC/AIR OPTIONS INCLUDING NO TARP SYSTEM) | 9. UNIBODY DESIGN FLOOR |
| 4. 30" FIXED SIDES | 10. 30" CABSHIELD (OPTIONAL) |
| 5. 42" FIXED SIDES | 11. 5" SHEDDING APRON |
| 6. 48" AIR LATCHED TAILGATE (HIGH LIFT OPTIONAL) | |